

絶縁帯設置図(例)

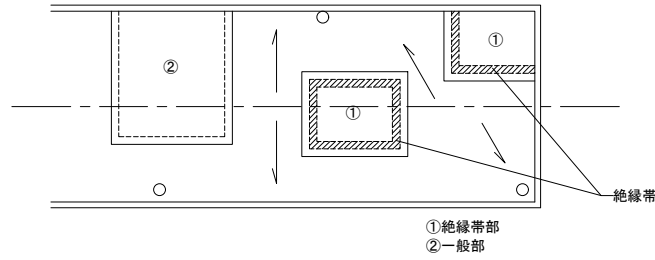

①絶縁帯部

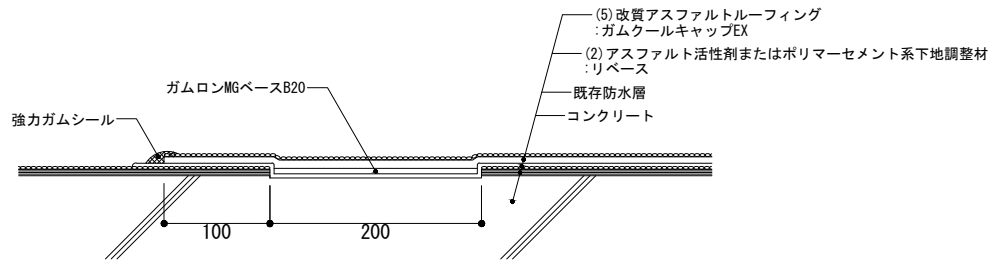

②一般部

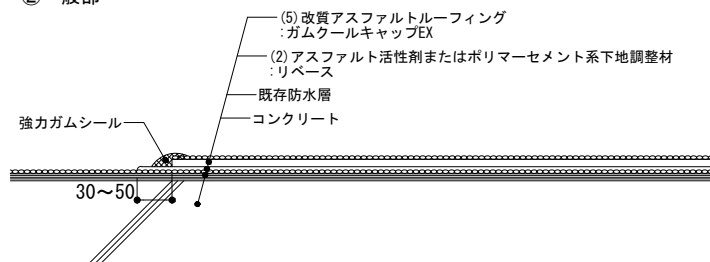

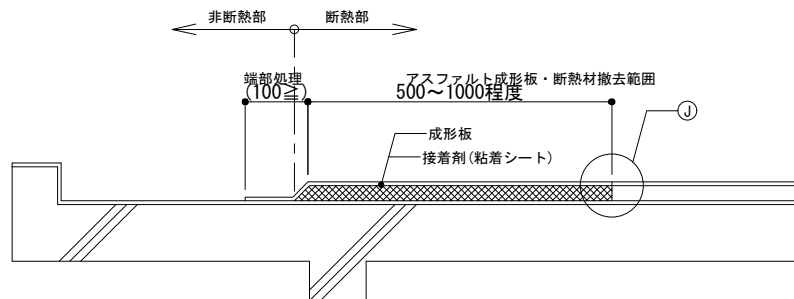
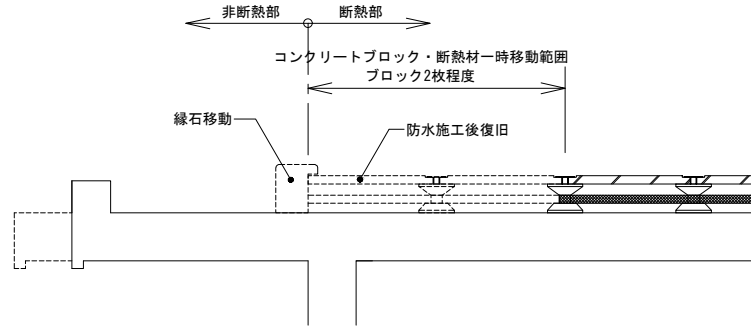

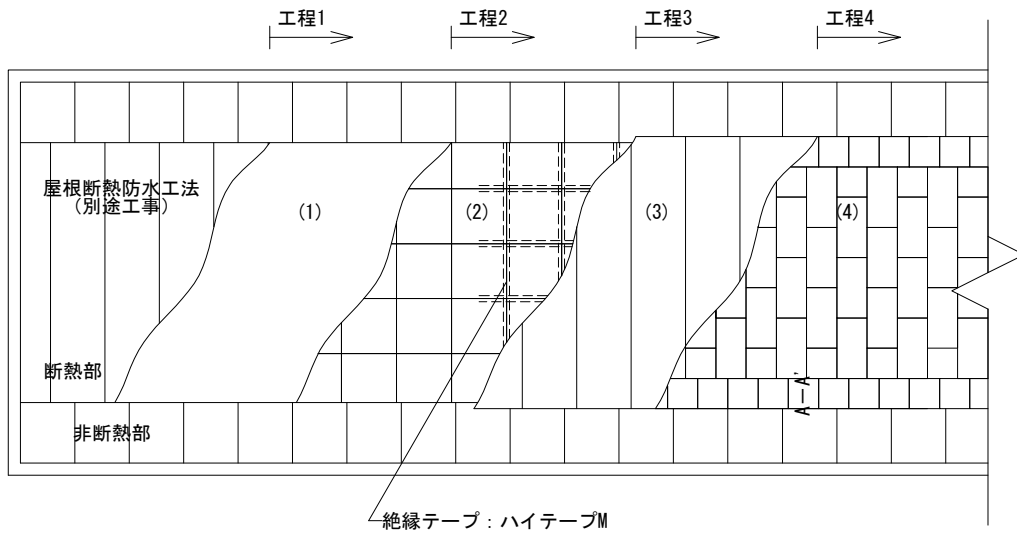

標準割付け図 (A-A')

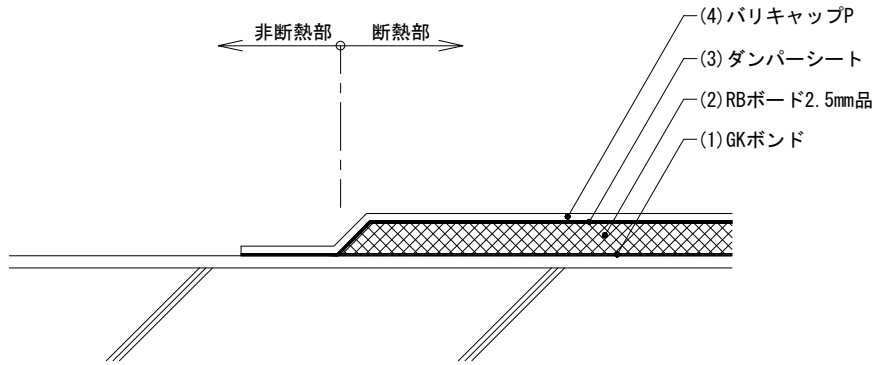

(現状・撤去範囲)
コンクリートブロック工法

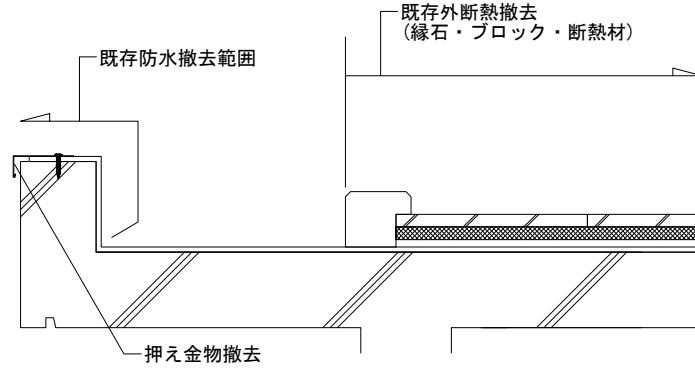

(現状・撤去範囲)
成形板工法

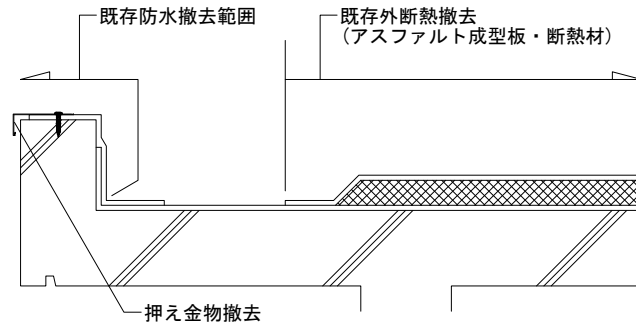

(修繕工法)

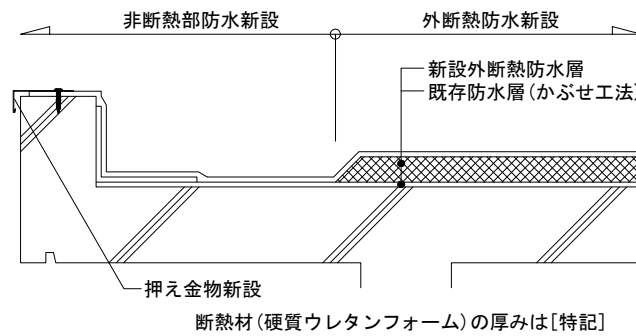

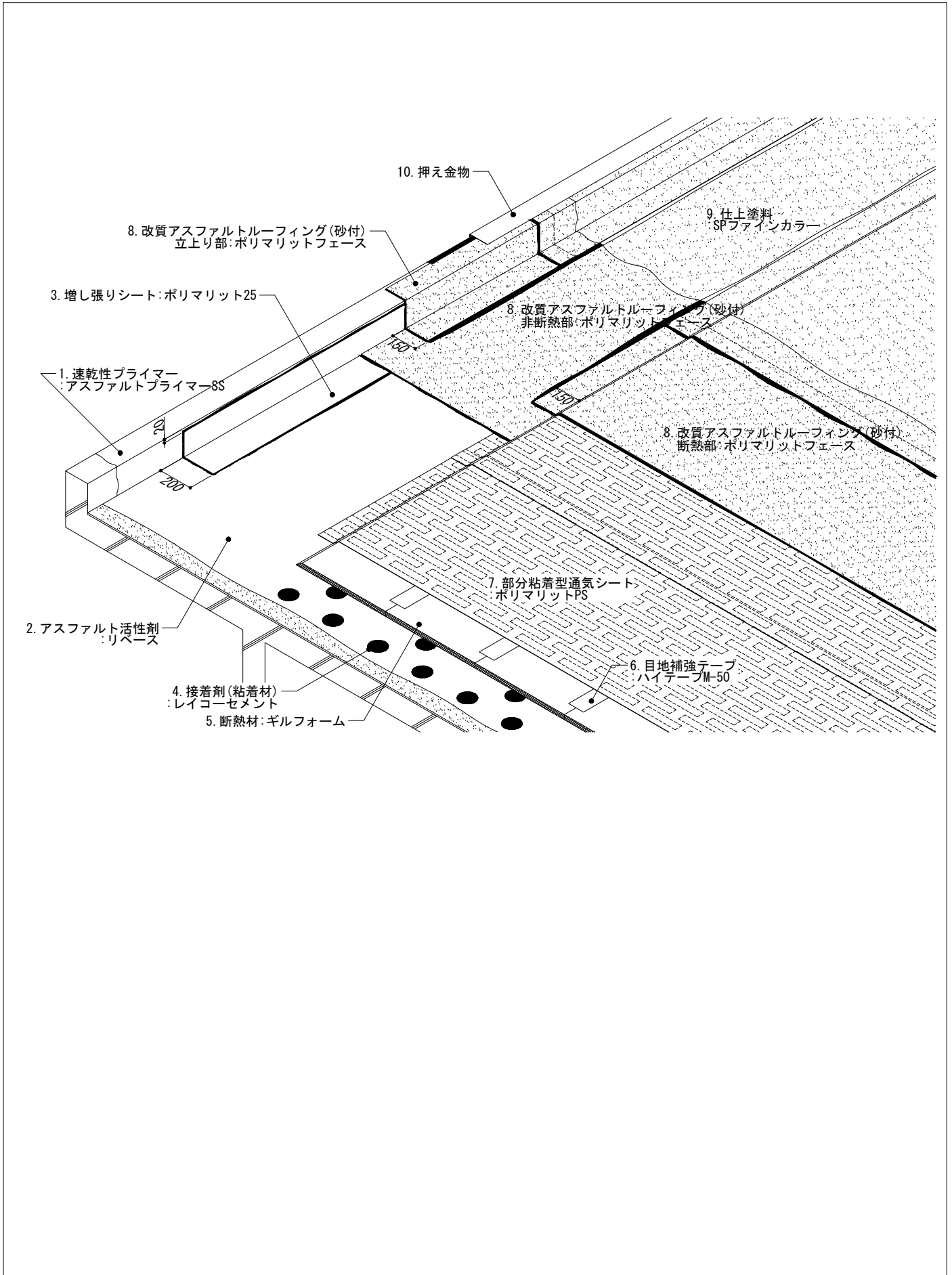

水抜きシート参考図

1. 既存防水層撤去

ドレン中心より周辺部500mm程度撤去

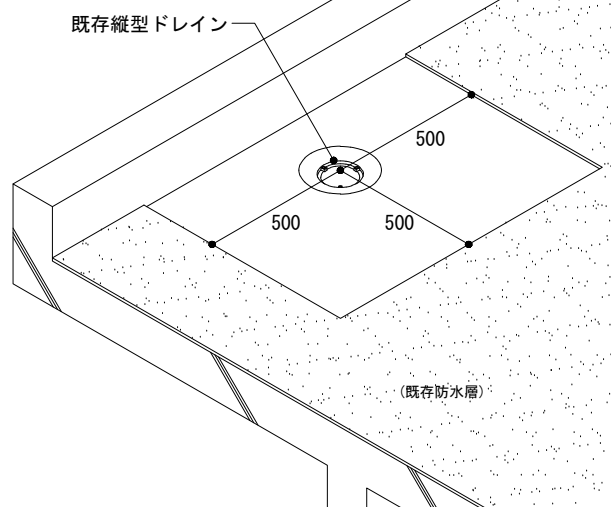

2. ドレン廻り増張り

製品名:ポリマリット25
既存防水層に150mm以上張り掛ける

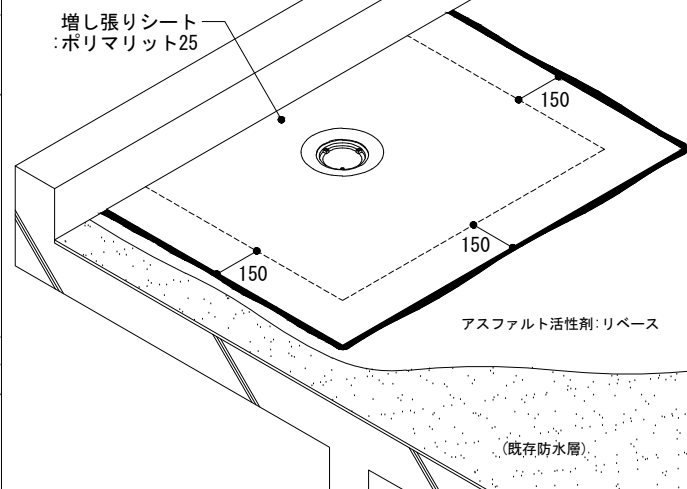

3. 入隅部増張り

製品名:ポリマリット25
平場に200mm以上張り掛ける

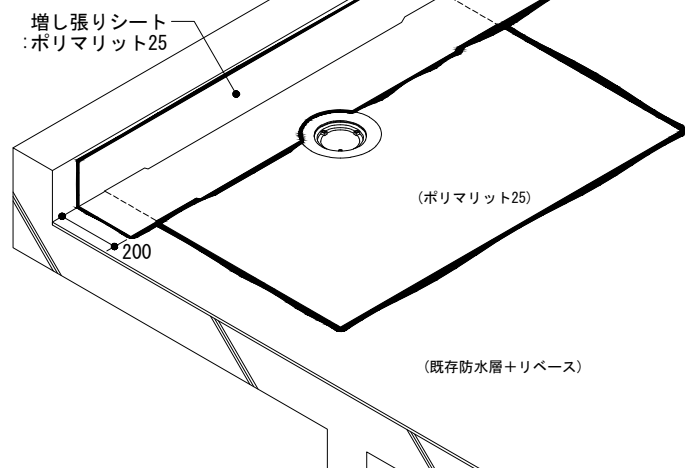

4. 水抜きシート張付け

製品名:ポリマリットPS
幅800mm以上 ドレン中央部から断熱材下に掛かるまで張り付ける

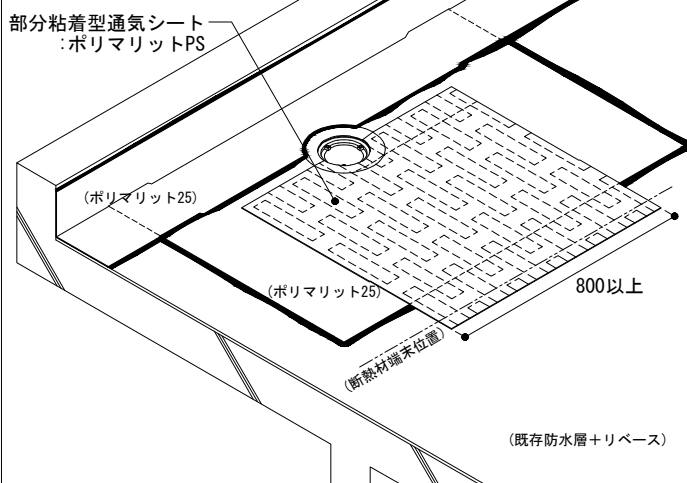

5. 改修用ドレイン設置 断熱材、部分粘着型通気絶縁用シート張付け

製品名:リードレンC
断熱材:ギルフォーム
部分粘着型通気絶縁用シート:ポリマリットPS

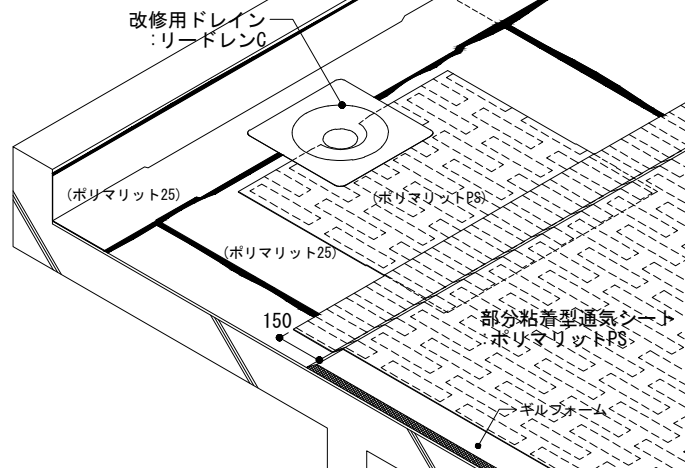

6. 改質アスファルトルーフィング(露出単層防水用)張付け

製品名:ポリマリットフェース

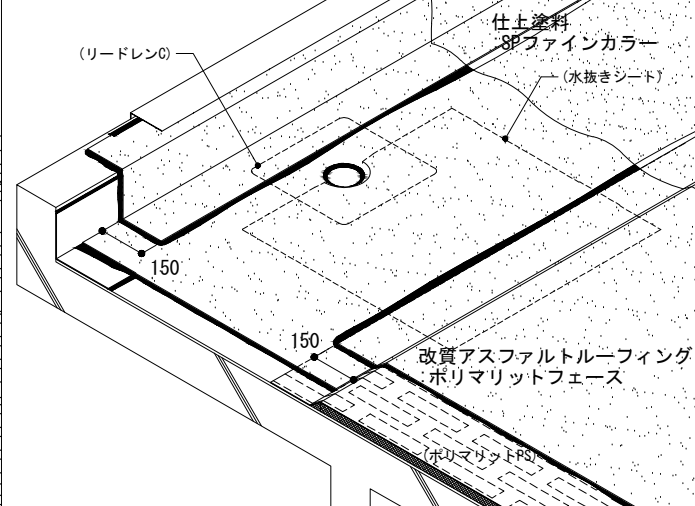

1. 全体図

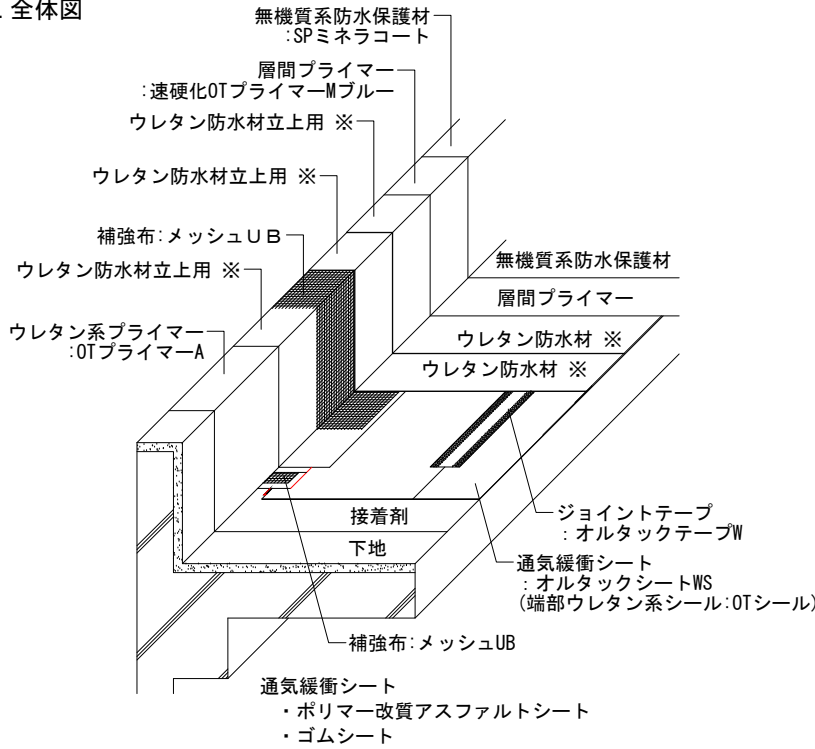

2. パラペット

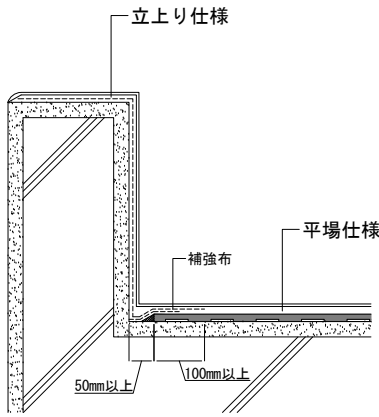

3. 壁面立上り

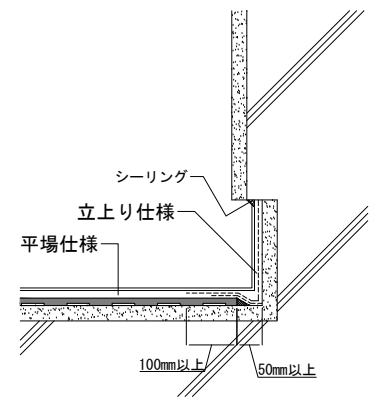
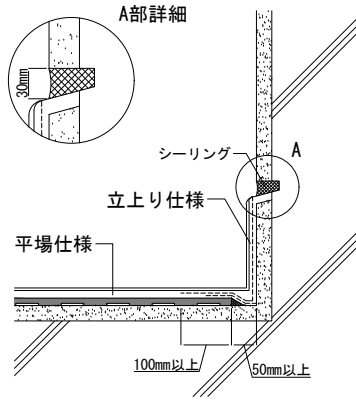

4. 側溝部

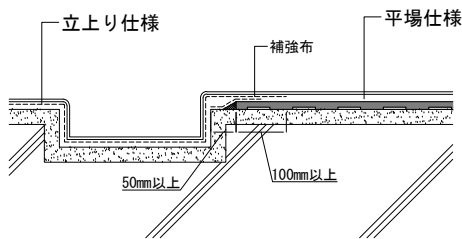

5. 架台廻り

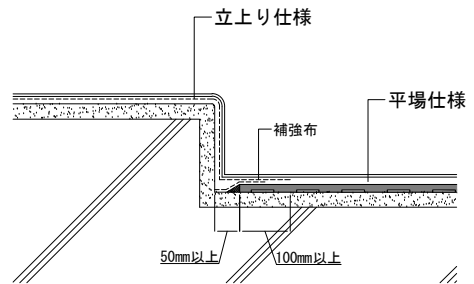

6. 手すり等支柱まわり

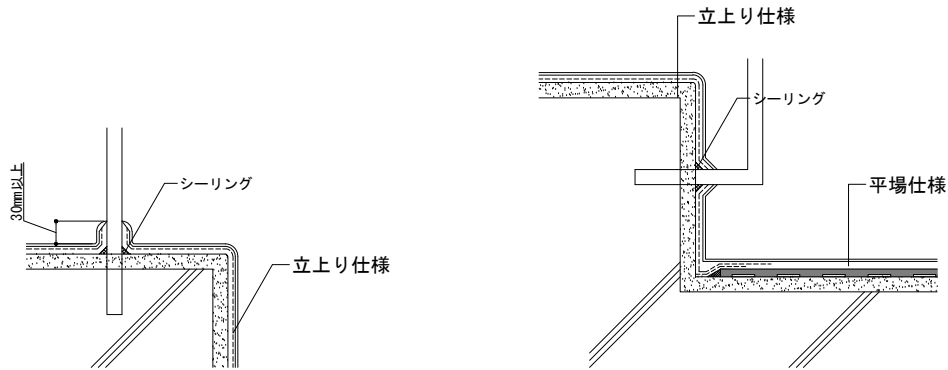

7. 脱気筒取り付け

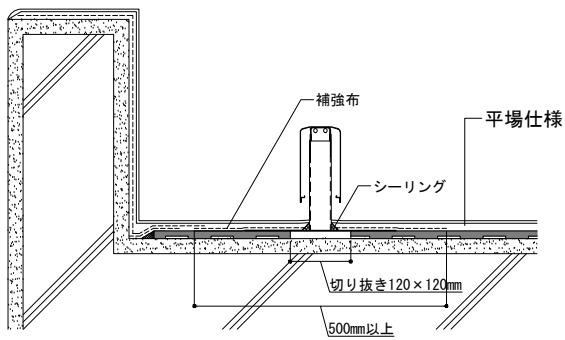

8. たて型ドレン

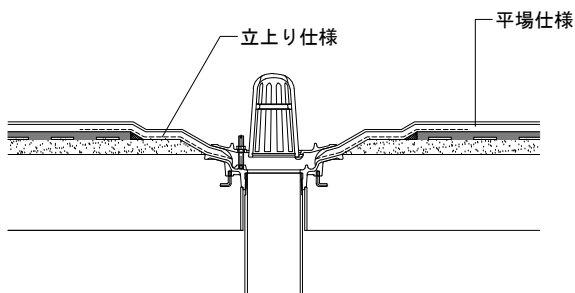

9. 横型ドレン

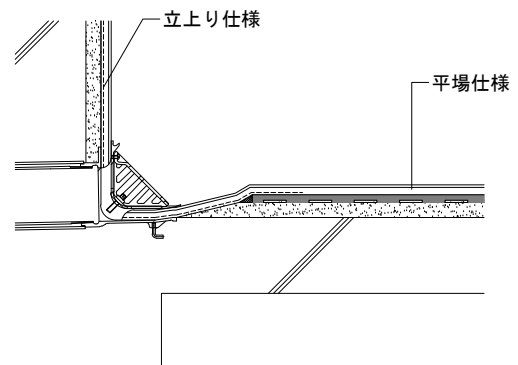

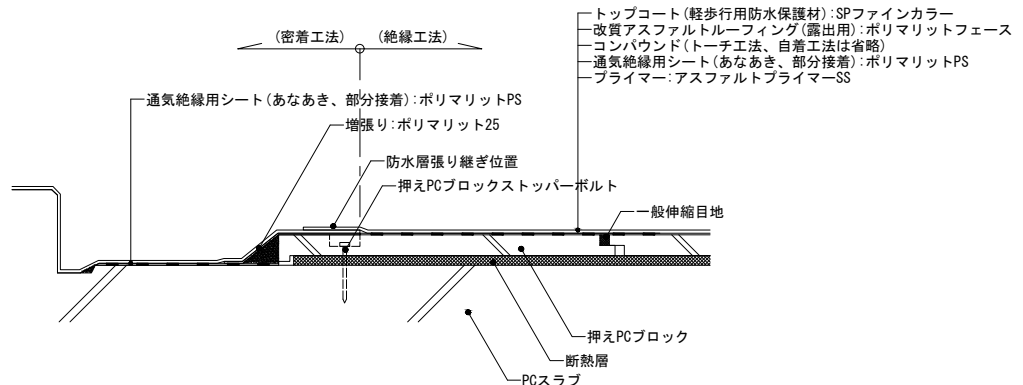
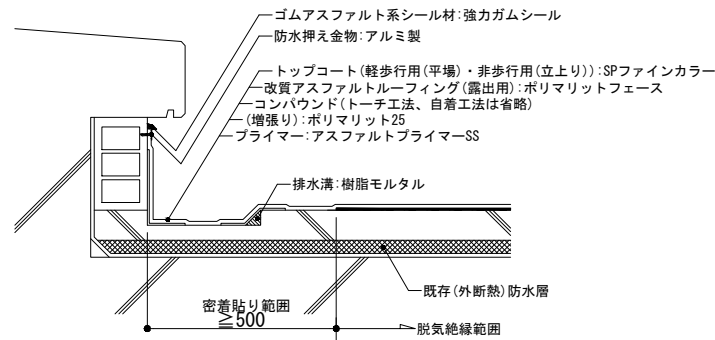
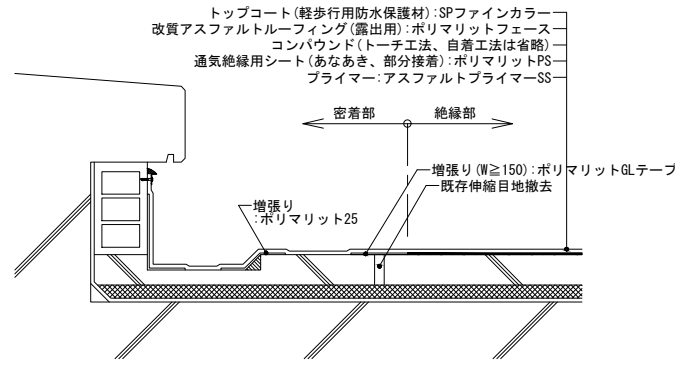

横引きドレン

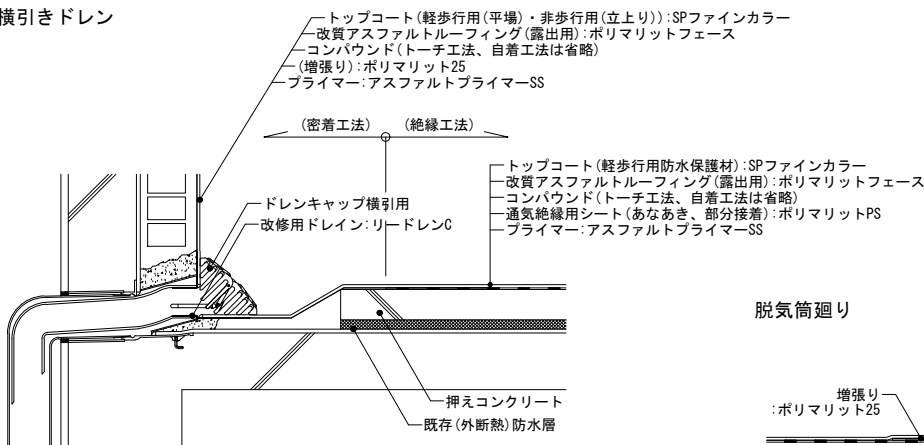

脱気筒廻り

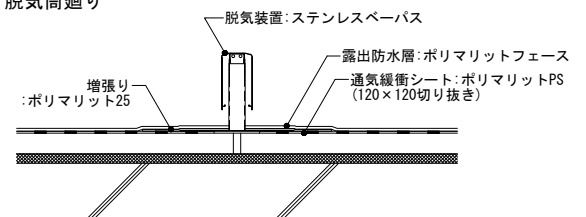

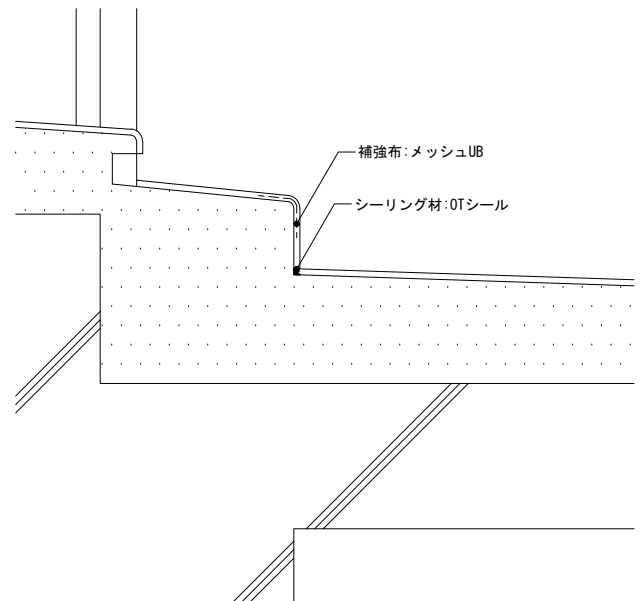
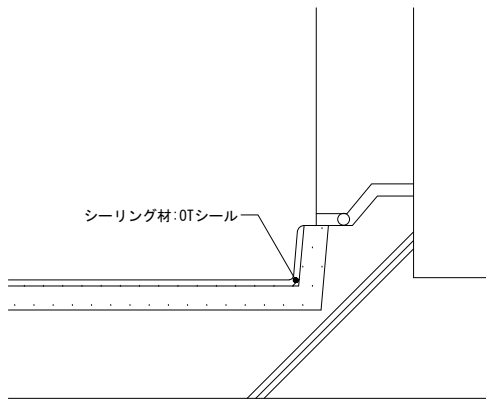
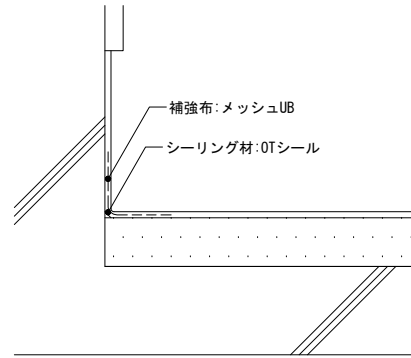
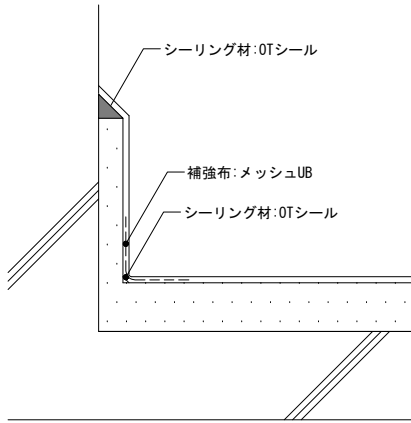
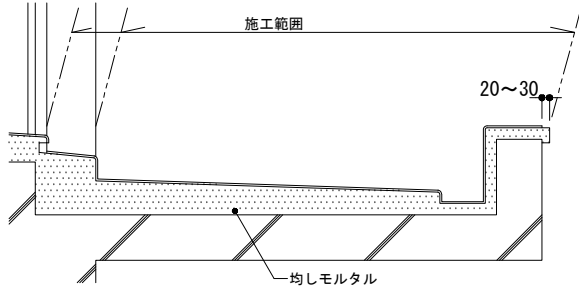

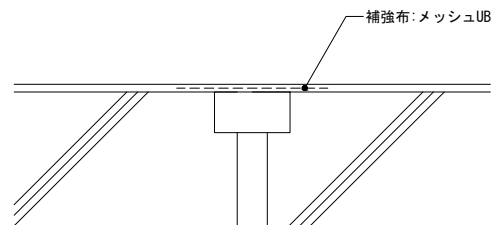
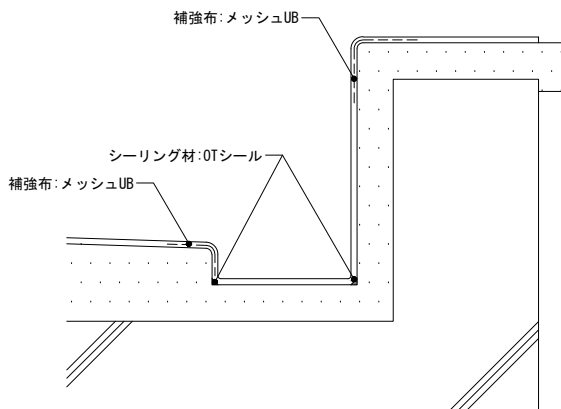
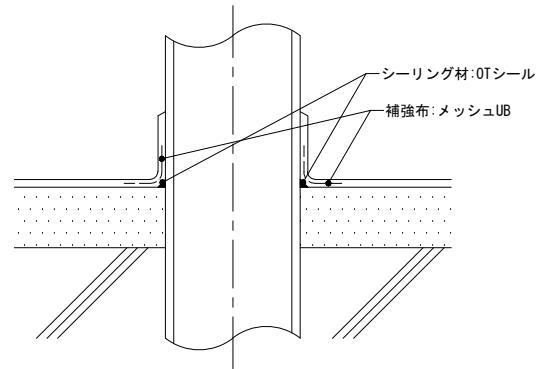
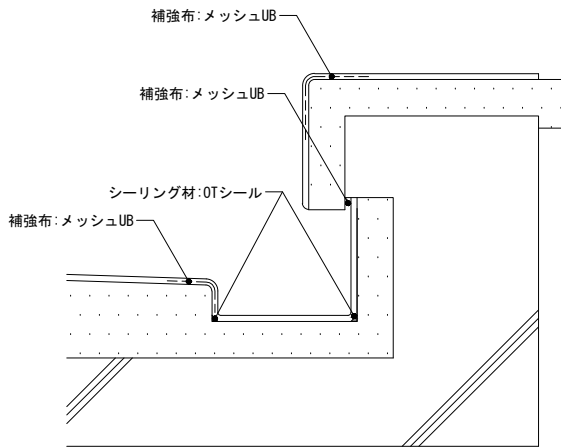
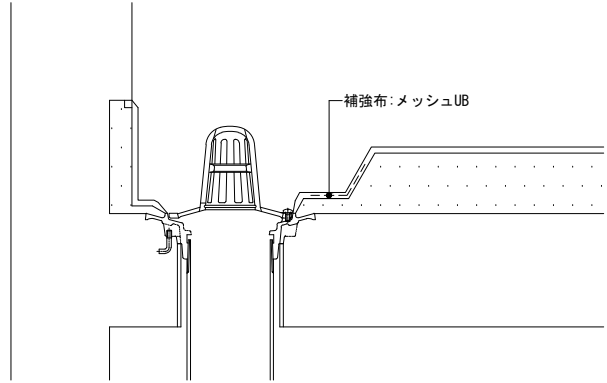
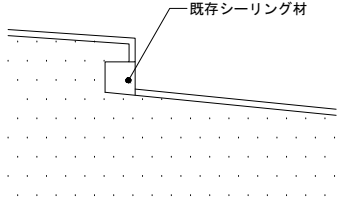

新規防水改修工法

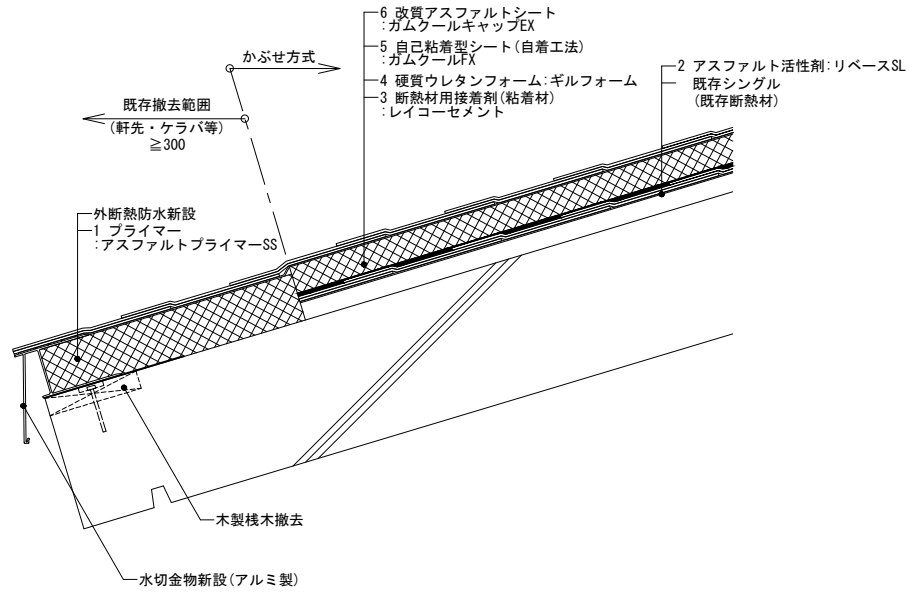

棟部分 新規防水施工

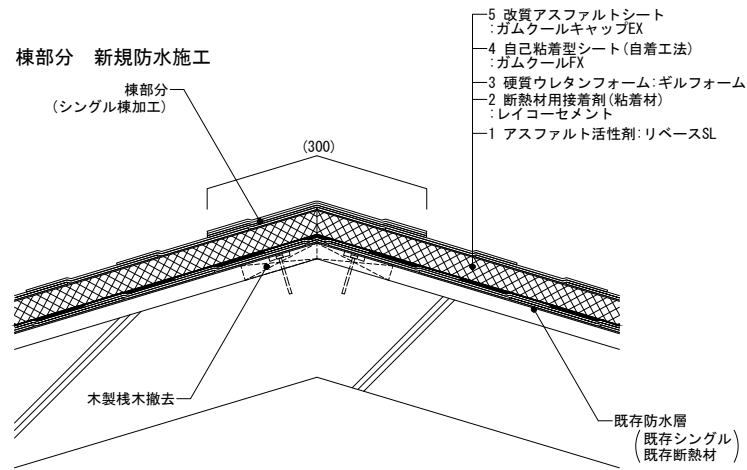

壁立上り部分 新規防水施工

